



SERIES 40PF 4 x 3 x 8.5 FM

FILE NO:	F40.63
DATE:	Nov. 29, 2010
SUPERSEDES:	F40.63 & F40.66
DATE:	Jan 15, 2001

End Suction Pump

ELECTRIC DRIVEN

SUBMITTAL

JOB: _____	REPRESENTATIVE: _____
ENGINEER: _____	ORDER NO: _____ DATE: _____
CONTRACTOR: _____	SUBMITTED BY: _____ DATE: _____
	APPROVED BY: _____ DATE: _____

TAG/REF:									
PUMP DATA	FLOW	HEAD	MOTOR DATA	HP	RPM	VOLT	PH	Hz	ENCLOSURE
SPECIAL STARTING:									

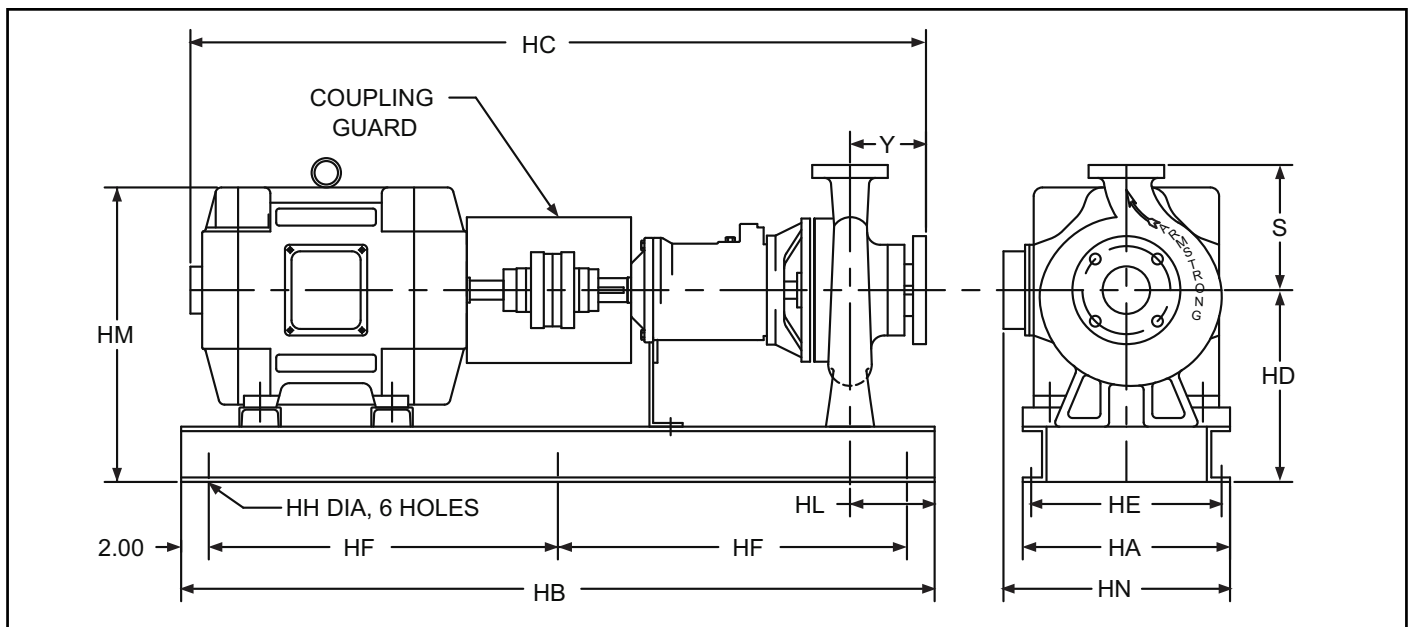

MOTOR FRAME	DIMENSIONS (in.)												WEIGHT lbs.	
	HA	HB	HC	HE	HF	HH	HM	HN	HD	X	Y	HL		S
254T	23.00	70.00	47.74	21.50	33.00	0.88	23.63	21.58	17.45	11.50	4.00	4.50	11.00	847
256T			49.48											
284TS			49.59											
286TS			51.09											
324TS			52.65											
326TS			54.15											
364TS			56.11											
365TS			56.11											

- FLANGE RATING**
- ANSI 125# (STD)
 - ANSI 250#
 - PN 16
- FIRE PUMP LISTING**
- UL
 - ULC
 - FM

DO NOT USE FOR CONSTRUCTION UNLESS CERTIFIED

S. A. Armstrong Limited
 23 Bertrand Avenue
 Toronto, Ontario
 Canada, M1L 2P3
 T: 416-755-2291
 F: 416-759-9101

Armstrong Pumps Inc.
 93 East Avenue
 North Tonawanda, New York
 U.S.A. 14120-6594
 T: 716-693-8813
 F: 716-693-8970

Armstrong Integrated Limited
 Wenlock Way
 Manchester
 United Kingdom, M12 5JL
 T: +44 (0) 8444 145 145
 F: +44 (0) 8444 145 146



© S.A. Armstrong Limited 2010

For Armstrong locations worldwide, please visit www.armstrongintegrated.com