



SERIES 40PF 8 x 5 x 11.5 FM

FILE NO: F40.612
 DATE: Nov. 29, 2010
 SUPERSEDES: F40.612 & F40.632
 DATE: June 11, 2004

End Suction Pump

ELECTRIC DRIVEN

SUBMITTAL

JOB: _____	REPRESENTATIVE: _____
ENGINEER: _____	ORDER NO: _____ DATE: _____
CONTRACTOR: _____	SUBMITTED BY: _____ DATE: _____
	APPROVED BY: _____ DATE: _____

TAG/REF:									
PUMP DATA	FLOW	HEAD	MOTOR DATA	HP	RPM	VOLT	PH	Hz	ENCLOSURE
SPECIAL STARTING: _____									

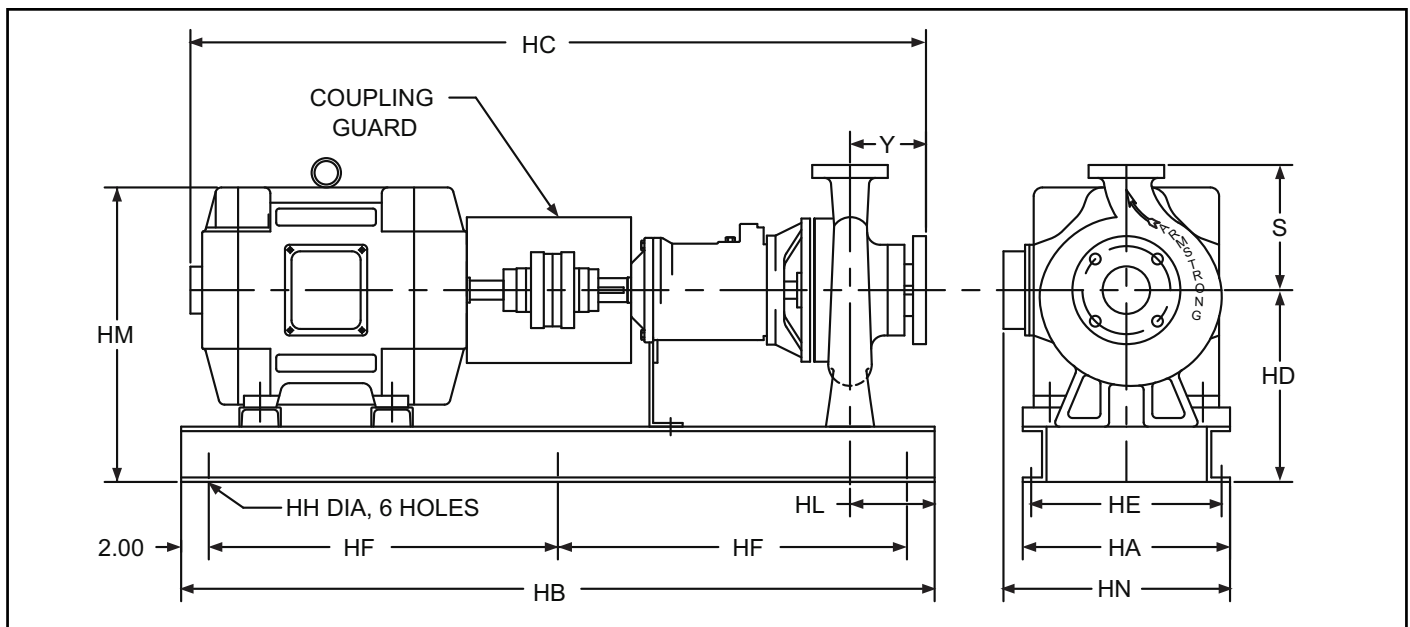

MOTOR FRAME	DIMENSIONS (in.)												WEIGHT lbs.			
	HA	HB	HC	HE	HF	HH	HM	HN	HD	X	Y	HL		S		
284TS	23.00	75.00	54.62	21.50	35.50	0.88	26.25	22.37	19.18	11.50	6.00	6.50	14.00	2023		
286TS			56.12													
324TS			57.68													
326TS			59.18				27.13	23.00							2518	
364TS			61.14													
365TS			64.64													
404TS			69.59				30.89	30.71								2958
405TS																
444TS																
445TS																

- FLANGE RATING**
- ANSI 125# STD
 - ANSI 250#
 - PN 16
- FIRE PUMP LISTING**
- UL
 - ULC
 - FM

DO NOT USE FOR CONSTRUCTION UNLESS CERTIFIED

S. A. Armstrong Limited
 23 Bertrand Avenue
 Toronto, Ontario
 Canada, M1L 2P3
 T: 416-755-2291
 F: 416-759-9101

Armstrong Pumps Inc.
 93 East Avenue
 North Tonawanda, New York
 U.S.A. 14120-6594
 T: 716-693-8813
 F: 716-693-8970

Armstrong Integrated Limited
 Wenlock Way
 Manchester
 United Kingdom, M12 5JL
 T: +44 (0) 8444 145 145
 F: +44 (0) 8444 145 146



© S.A. Armstrong Limited 2010

For Armstrong locations worldwide, please visit www.armstrongintegrated.com